

Assembly Instructions

Before assembly

- We recommend that time is taken to read the instructions before starting assembly, then follow the easy step by step guide. The instruction sheet is only a guide to the assembly. Certain items may not be shown to scale.
- Check all components prior to assembly
- This product should be assembled by no less than two people
- Drill all components where indicated



Recommended tools for assembly

- Power Drill/Screwdriver
- Crosshead drill bit
- 3mm diameter drill bit
- 12mm diameter drill bit
- Hammer
- Sharp knife
- Spirit level
- Silicon sealant
- Step ladder
- Hacksaw

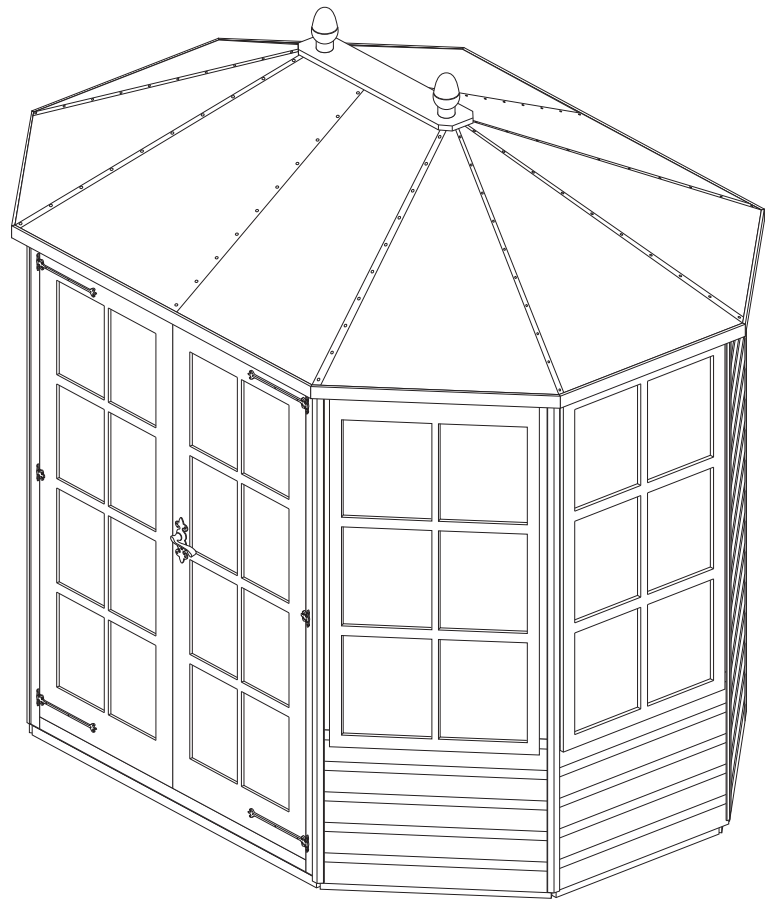
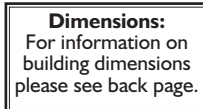

No.	Components	Qty.
1	Floor	1
2	Back wall panel	1
3	Plain wall panel	2
4	Small window panel	4
5	Door panel	1
6	Left door (Catch plate rebate)	1
7	Right door (Lock rebate)	1
8	Window frame	4
9	Roof centre block	1
10	Large roof panel	2
11	Small roof panel	6
12	Roofing felt roll (5m)	2
13	Roof cap (640mm)	1
14	Inside roof cover (670mm)	1
15	Acorn finial	2
16	Short bargeboard	6
17	Long bargeboard	2
18	Corner coverstrip	16
19	Window glazing (372x 263mm)	24
20	Door glazing (372x 190mm)	16
21	Window panel coverstrip (35x38x1200mm)	8
22	Window/door beading (15 x 15 x 345mm)	80
23	Window beading (15 x 15 x 270mm)	48
24	Door beading (15 x 15 x 195mm)	32

No.	Fixing Kit	Qty.
25	Door lock and catch plate set	1
26	Door handle kit	1
27	Door handle spindle	1
28	Door hinge 300mm (12")	4
29	Door hinge 75mm (3")	2
30	Tower bolt	2
31	Window hinge	8
32	Window stay (black)	4
33	63mm screws	78
34	50mm screws	28
35	25mm screws	40
36	25mm black screws	80
37	25mm brass screws	4
38	20mm screws	16
39	19mm roundhead screws	8
40	30mm nails	88
41	25mm panel pins	400
42	10mm Felt nails	220

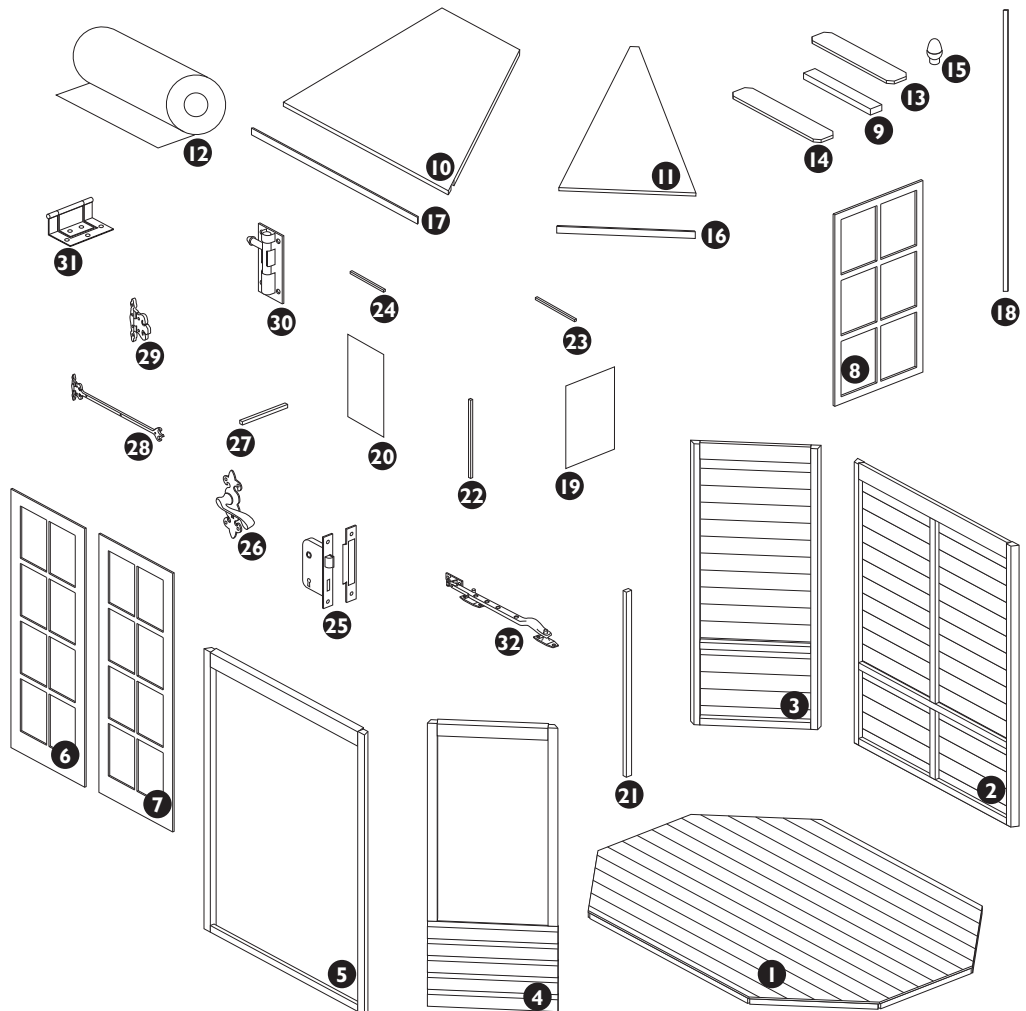

1. Floor

Prepare a level area for the summerhouse. Place the floor in to position and ensure level.

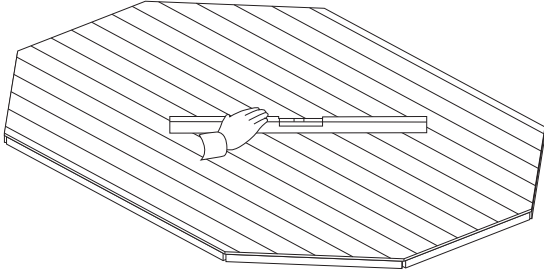

To **VALIDATE** the guarantee, this item should be erected on 50mm x 50mm treated wooden or similar bearers (**These are not supplied with the kit.**) Ground contact must be avoided.

2. Doors

Lay the door panel on the floor. Position the doors in the opening, ensure the right-hand door has the holes for the door handle and lock is positioned on the right-hand side. With the doors evenly spaced around the edge and between each door, secure the hinges in the positions shown below using 9 x 25mm black screws for the 300mm hinge and 6 x 25mm black screws for the 75mm hinge.

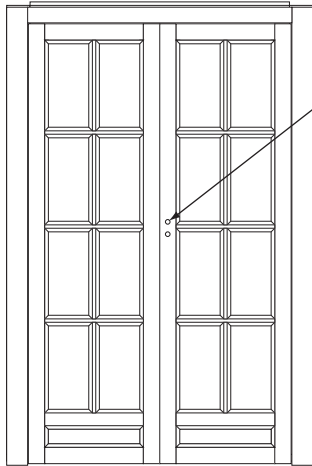

Important:
Ensure the door panel is the right way up and the right-hand door (with the holes for door handle and lock) is fitted to the right-hand side.

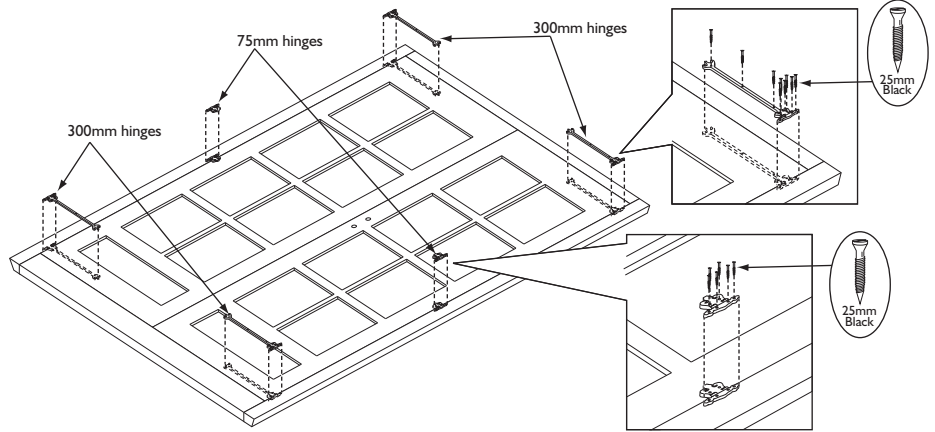

3. Opening Window

Lay the window panel on the floor. Fit the hinges in the rebates on the short edge of the window frame as shown in the diagram using 2 x 20mm screws per hinge, stand the hinge end of the window on the window panel, making sure it is centred at the top of the window opening. Open the hinges and secure them to the window panel frame using 5 x 25mm screws per hinge. On the inside of the window panel fit the window stay and its two posts using 6 x 25mm screws as shown in the diagram.

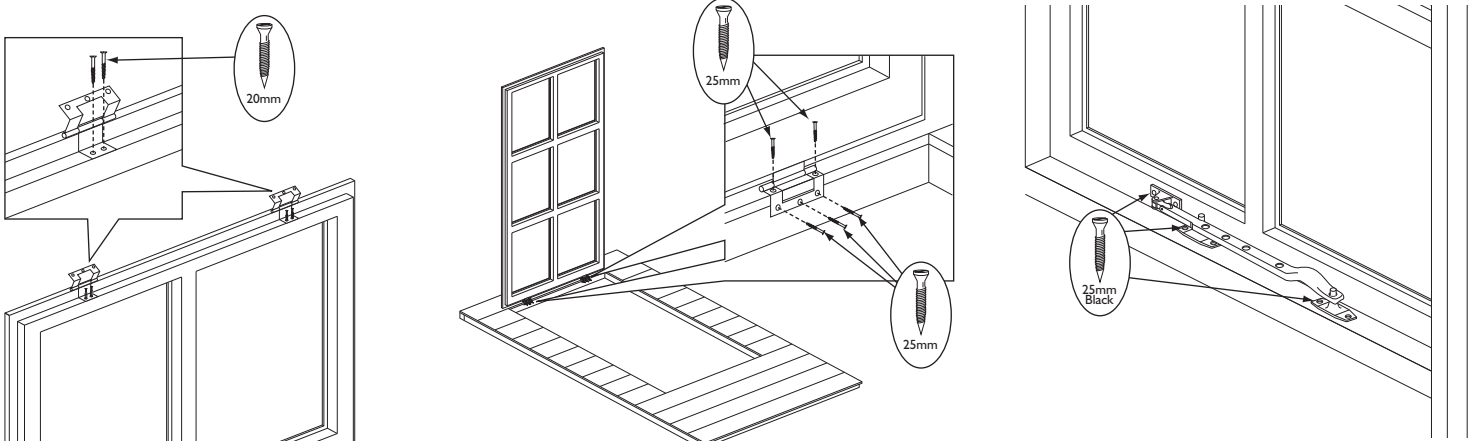

4. Glazing

Glazing the windows can be done once the building is assembled. However, it may be easier to install the glass whilst the panels are laid flat on the ground. Working on one panel at a time lay each door and window panel flat. Apply a very small bead of waterproof silicon sealant around each glazing rebate. Carefully place a window pane into each rebate. Secure each pane in place by pinning the window beading into position using 2 x 25mm panel pins per horizontal bead and 3 x 25mm panel pins per vertical bead. Repeat for each pane of glass for all windows and doors.

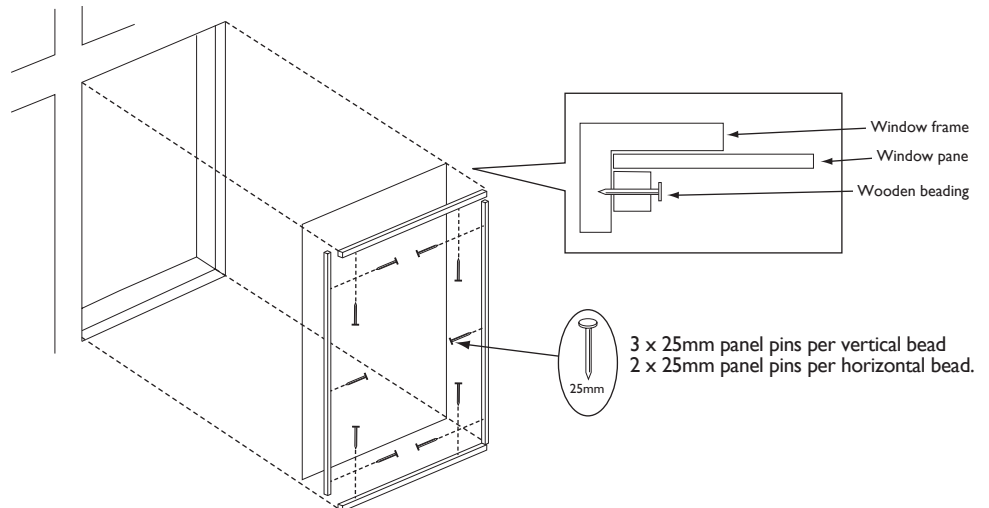
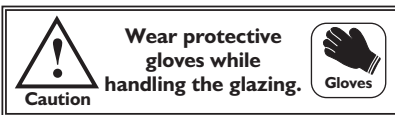

3 x 25mm panel pins per vertical bead
2 x 25mm panel pins per horizontal bead.

5. Wall panels

Position a plain wall panel and a window panel on the floor as shown in the first diagram. Note how the panel frames sit on the floor with the panel cladding overhanging the floor edge. Ensure square and secure using 4 x 63mm screws, screw through the frame of the window panel into the frame of the plain panel. Align the back panel next to the plain panel and secure in the same way using 4 x 63mm screws. Continue to add the rest of the panels in the same way.



It is recommended to drill pilot holes with a 3mm drill bit for all screws in this section.

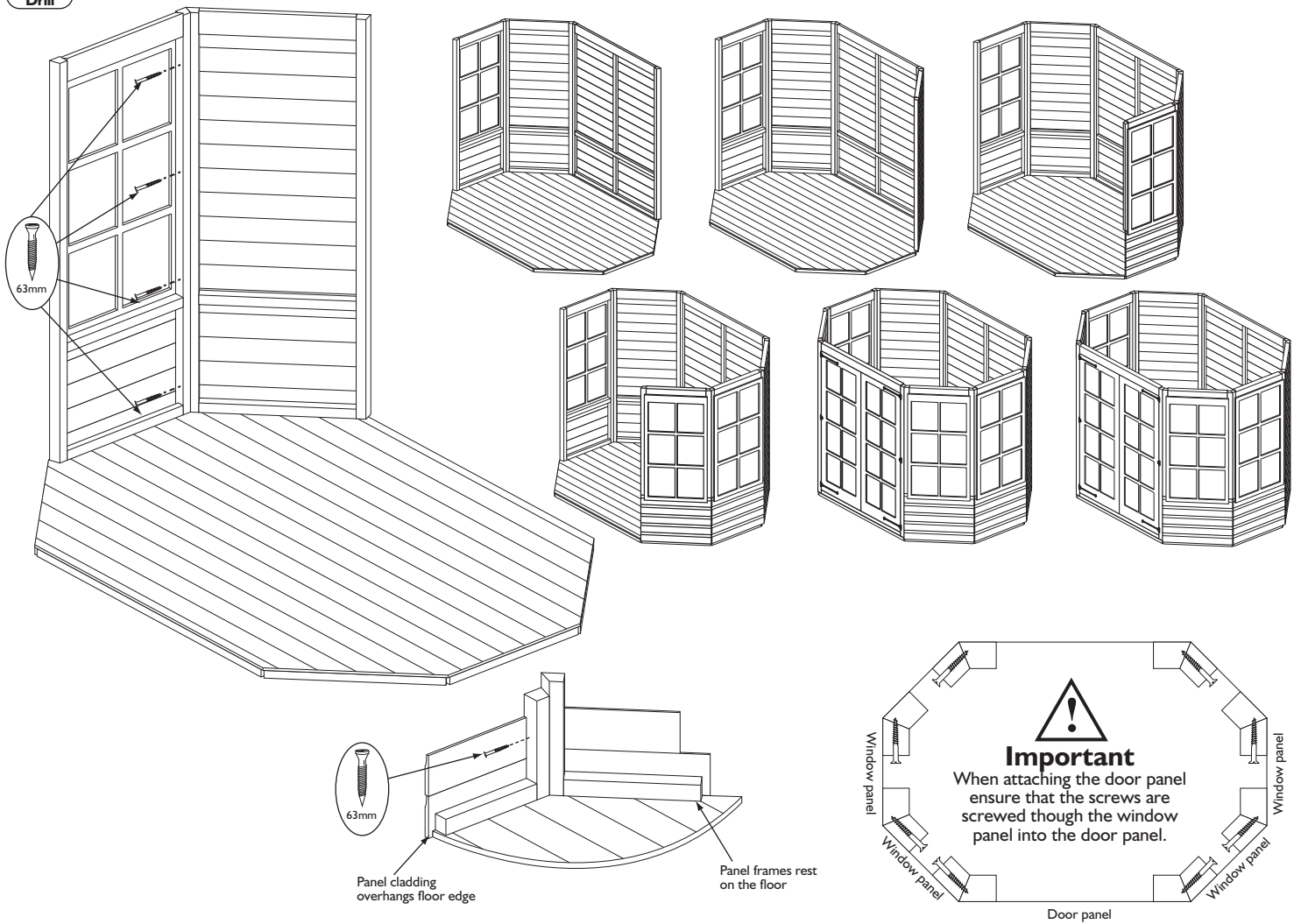

6. Door handle & tower bolts

Push the door lock into the rebate on the edge of the right-hand door as shown and secure using 2 x 25mm brass screws. To fit the metal door handle, it first maybe necessary to cut the spindle bar down to 88mm. Push the spindle bar through the door latch mechanism. Fit a door handle to the metal spindle bar on each side of the door and secure them in place using 4 x 25mm black countersunk screws per handle. On the other door fit the lock plate using 2 x 25mm brass screws. Attach the tower bolts to the inside of the left door as shown using 4 x 19mm round head screws per bolt. Mark where the tower bolts touch the top and bottom door frame and drill a 12mm diameter hole for each bolt.

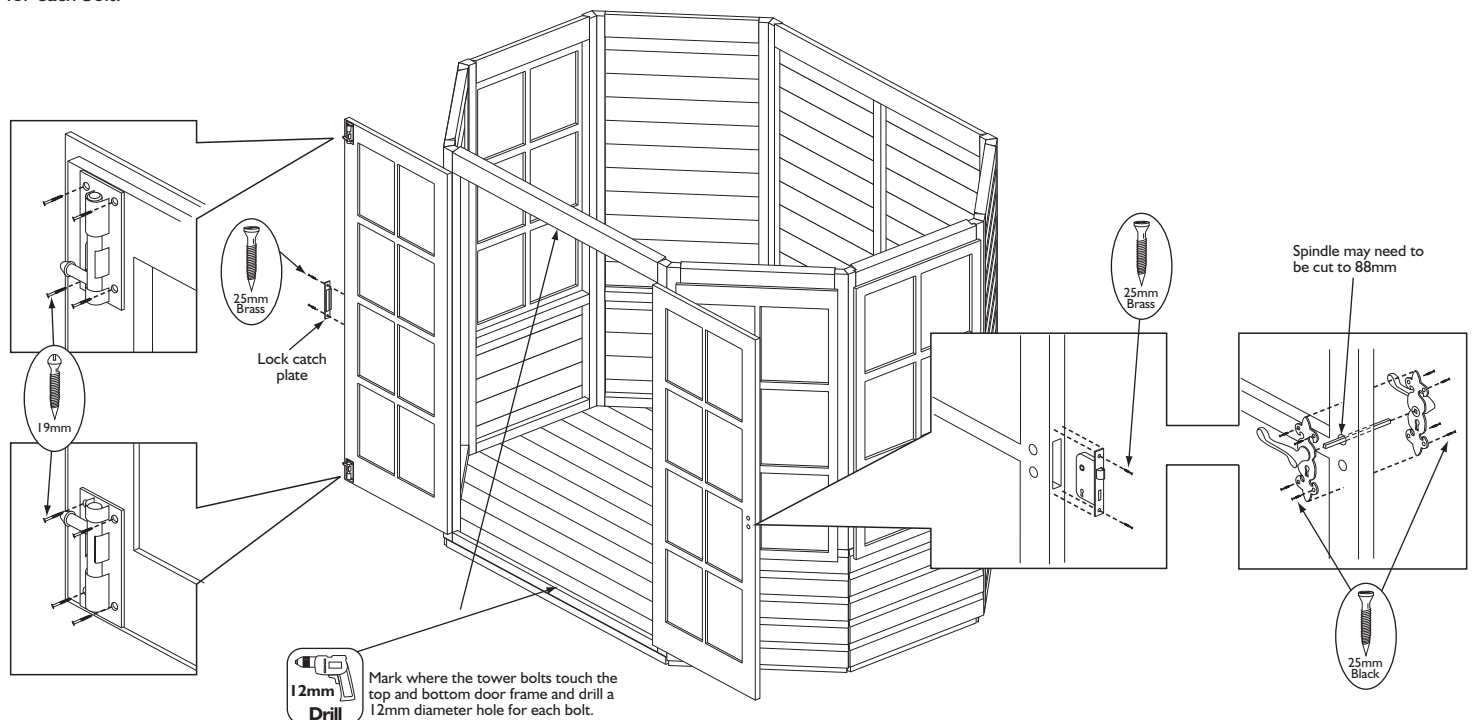

7. Walls to floor

With all the wall panels in position, check they are all sitting square on the floor and secure to the floor using 1 x 63mm screws for each small panel and 2 x 63mm screws for the larger back and door panels, screw through the wall panel frame and into the floor.

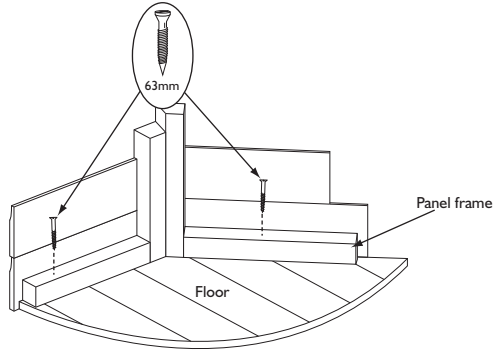
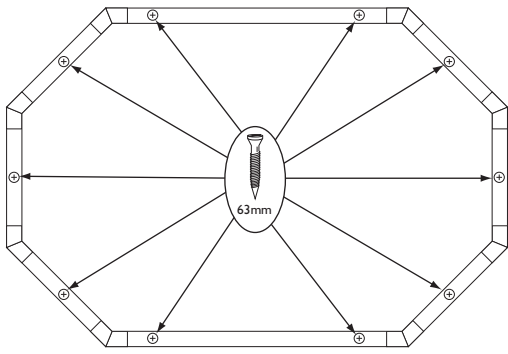

8. Window coverstrips

To each window panel attach two window coverstrip. On the inside, position the strip as shown and secure to the panel frame using 2 x 50mm screws per strip.

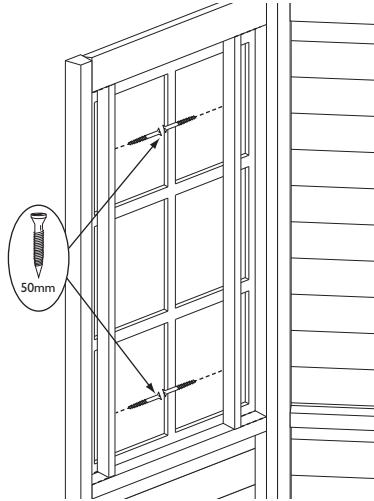

9. Roof panels

Lift a large roof panel onto the back of the building and a small roof panel on next to it. Ensure they are resting evenly next to each other and secure together through the panel frames using 2 x 63mm screws. So that adjustments can be made do not fully tighten these screws until all roof panels are in place. Have a second person holding the panels up while working round the roof adding the remaining panels. With all the roof panels in position and adjusted as necessary, fully tighten the screws. Attach the roof panels to the walls using 2 x 63mm screws per panel, screw through the roof panel frame into the top frame of the wall panel.



It is recommended to drill pilot holes with a 3mm drill bit for all screws in this section.

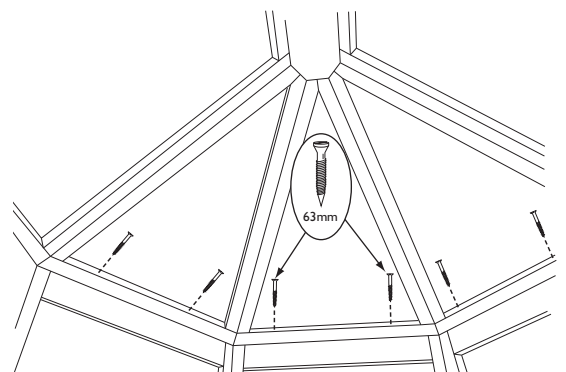
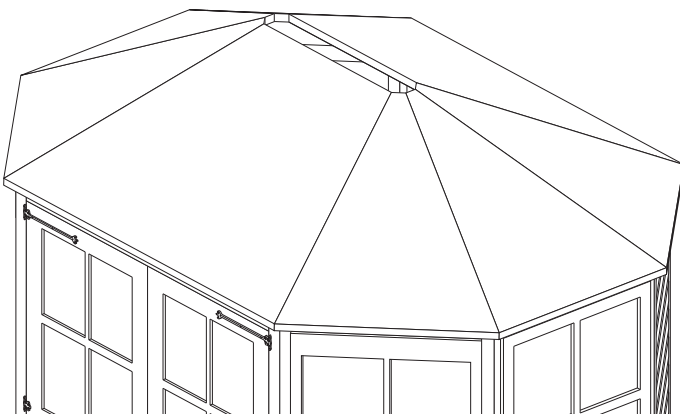
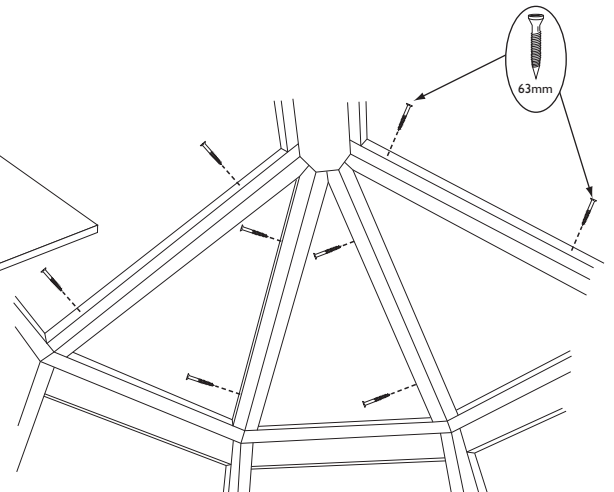
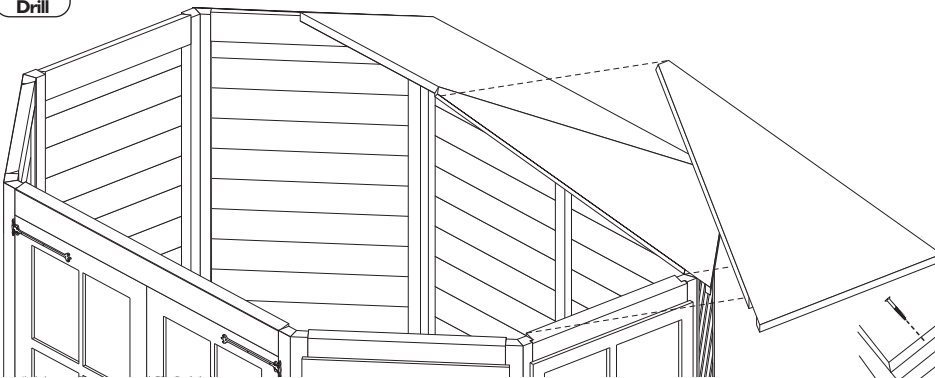

10. Roof felt

Unroll a roll of felt, carefully measure and cut out the six triangular shape pieces as shown in the first diagram below. For the second roll of felt carefully measure and cut out the left and right-handed triangular pieces as per the second diagram below.

ROLL 1 — Triangular felt pieces

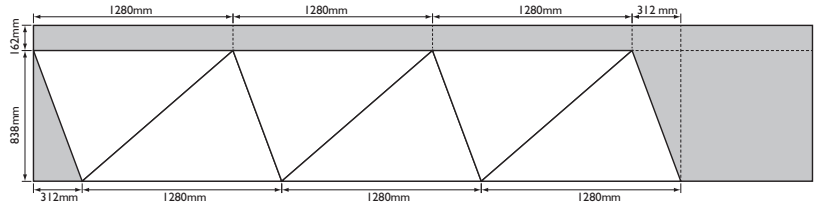
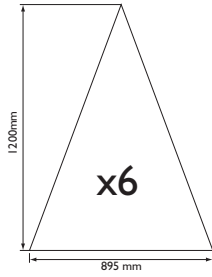

ROLL 2 — Left and right hand felt pieces

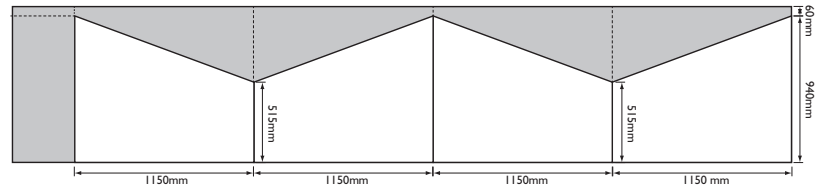
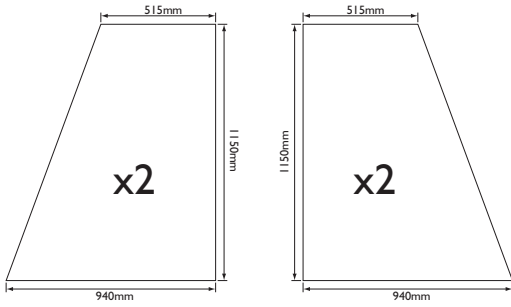

11. Fitting roof felt

Over a small roof panel lay a triangular felt piece. Align the left-hand felt edge with the edge of the roof panel. Along the bottom edge allow enough felt to fold over and cover the felt batten. The right-hand edge should overlap the next panel round. Once in position secure down the left edge using 4 x 10mm felt nails evenly spaced. Roll back the right-hand edge of the felt and attach another piece of felt in the same way as the first to the next panel round. Roll back into position the first felt. Repeat this for all the small roof panels and in the same way on the left side of each large roof panel with the large left-hand felt piece. Position a right-hand large felt on the right side of each large roof panel, ensure it overlaps the felt pieces either side and secure down one edge using 10 x 10mm felt nails evenly spaced. For each piece of felt, tension across the roof and secure down the edge using 10 x 10mm felt nails evenly spaced. Fold down the bottom edge of the felt and secure to the felt batten using 5 x 10mm felt nails per felt piece evenly spaced. If necessary trim of any excess felt along the bottom edge.

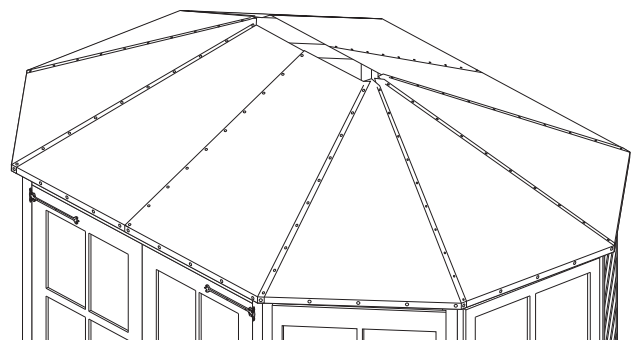
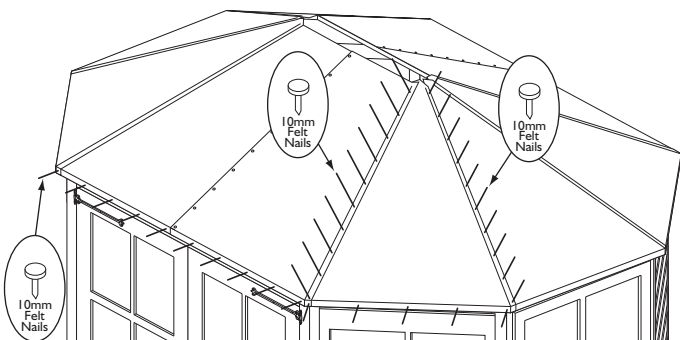
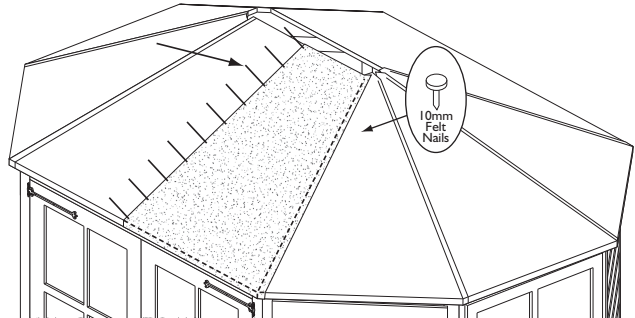
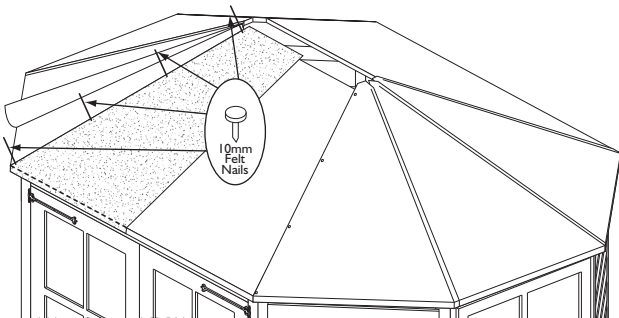
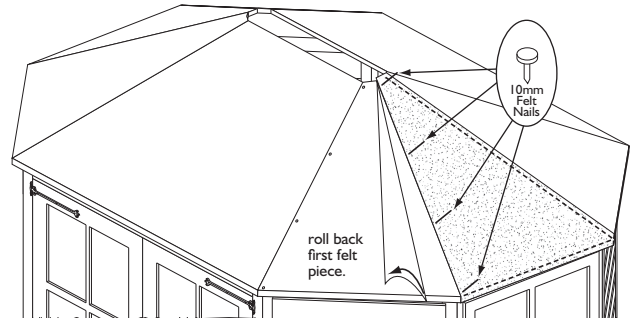
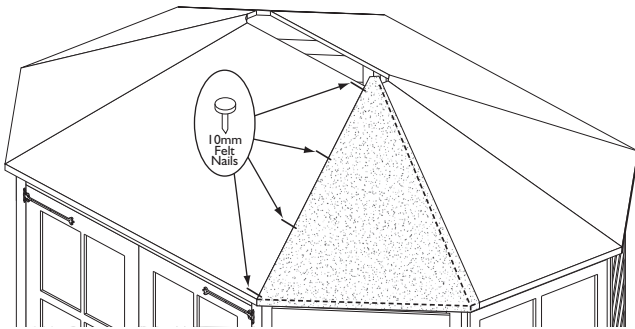

12. Bargeboard, finials and coverstrips

The two acorn finials centres are positioned about 90mm from the ends of the Roof cap. Secure the finials using 2 x 63mm screws per acorn. Position the roof cap centrally on the roof centre block and secure using 6 x 50mm screws, screw through the roof cap into the block. Place the finial assembly onto the roof so that the roof centre block fits in the hole. From inside the building attach the inside roof cover to the centre block using 6 x 50mm screws. Around the edge of the roof secure the bargeboards, ensure the top edge of the bargeboards are flush to the roof line and secure each board using 3 x 30mm nails.

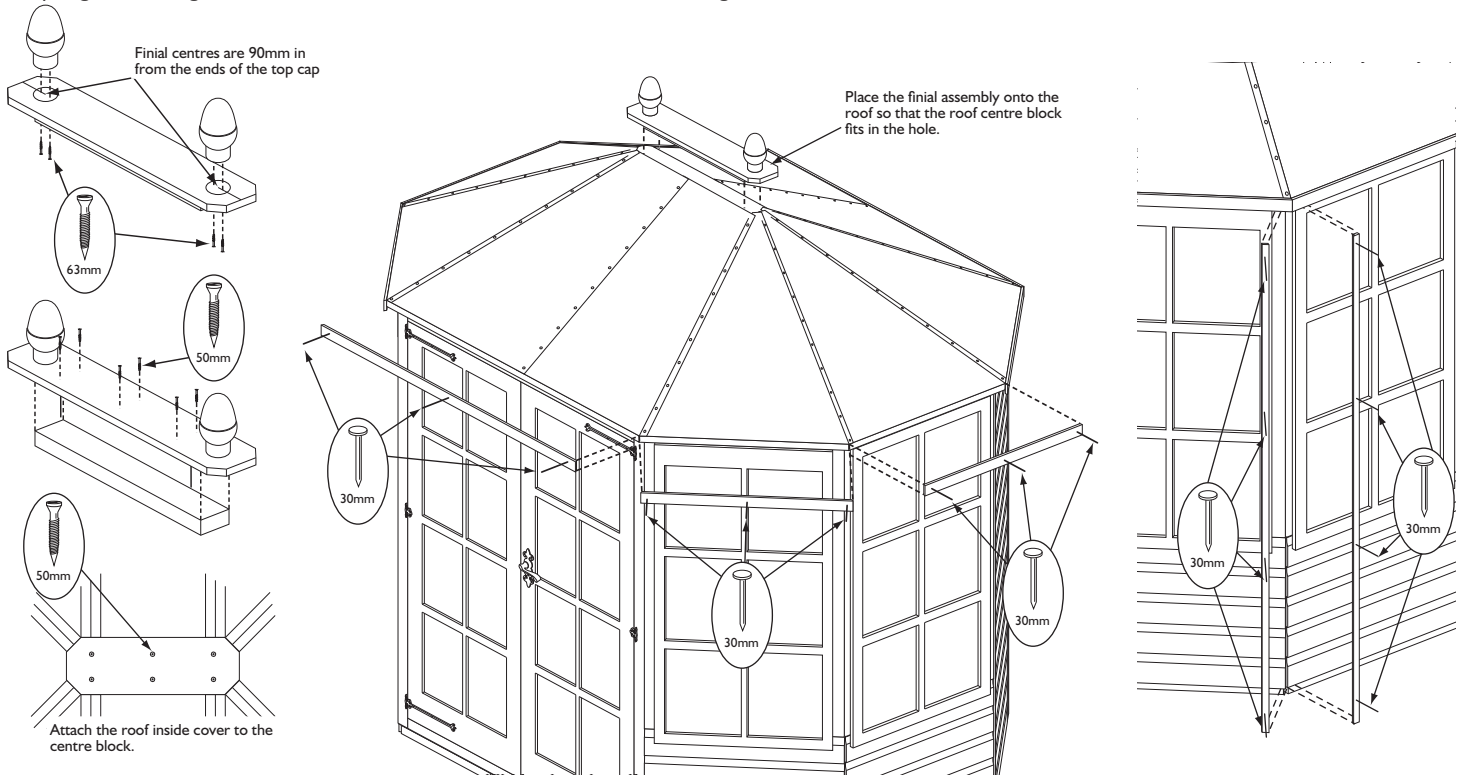

Dimensions

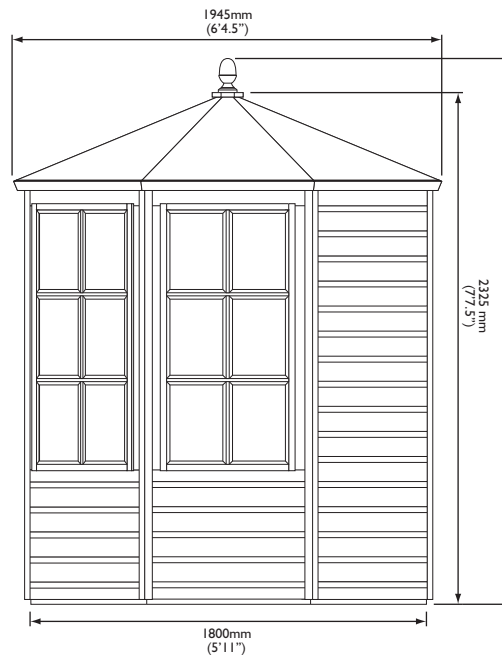
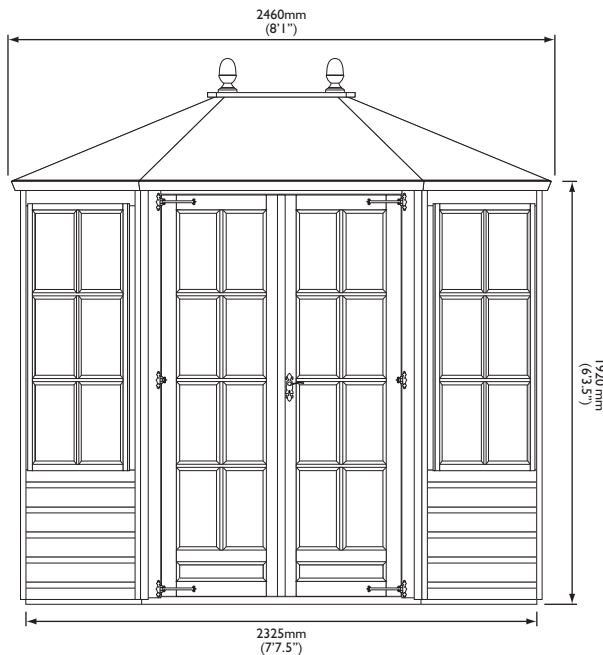

Footprint Dimensions

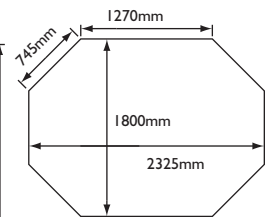

Minimum base size:

W= 2425mm
D= 1900mm

Door opening:

H= 1780mm
W= 1075mm

Important information - retain for future reference

Shiplap buildings come ready stained but this is only a preparatory treatment. To **VALIDATE** the guarantee, the building must be properly treated with a recognised external wood preserver **WITHIN 3 MONTHS** of assembly and **RE-TREATED ANNUALLY** thereafter. The building must also be erected on 50mm x 50mm treated wooden or similar bearers (These are not supplied with the kit.) Ground contact must be avoided.

Timber Information.

As timber is a natural material, there are certain weather conditions that may affect the materials properties. In times of excessive dry spells the material may lose some of its internal moisture causing a certain degree of shrinkage on a panel and in periods of excessive rain there will be a certain amount of swelling throughout the wooden panels. This process can not be avoided. If you have problems with certain boards shrinking in dry spells try to decrease the amount of direct sunlight on the building or the amount of air passing over the building. During hot spells spray water directly onto the panels with the aid of a garden hose.

If in doubt of any aspect regarding the assembly, use or safety of your summerhouse please contact us:

Help Line: (Normal Office Hours) 01829 261 121

Email: support@rowgar.co.uk

ROWLINSON GARDEN PRODUCTS LIMITED
Green Lane
Wardle Nr. Nantwich
Cheshire
CW5 6BN
www.rowgar.co.uk

We constantly improve the quality of our products, occasionally the components may differ from the components shown and are only correct at time of printing. We reserve the right to change the specification of our products without prior notice.

2018 © Rowlinson Garden Products Ltd