

Kashmir Arbour

English SS377A

email: support@rowgar.co.uk

Help Line (Normal Office Hours) 01829 261 121

Assembly Instructions

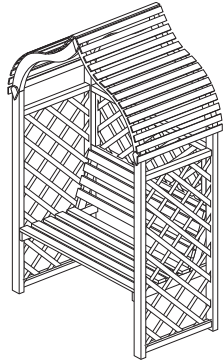

Biocidal Products Regulation EU 528/2012
Wolmanit® CX treated wood is a treated article that incorporates biocidal products: copper hydroxide carbonate/II and boric acid. They protect wood against fungal decay /rot/ and insect attack.
Keep away from food, drink and animal feeding stuffs. Avoid breathing dust when cutting treated wood.

Before assembly

- We recommend that time is taken to read the instructions before starting assembly, then follow the easy step by step guide. The instruction sheet is only a guide to the assembly. Certain items may not be shown to scale.
- Check all components prior to assembly
- Drill all components where indicated.
- This product should be assembled by no less than two people.
- Never attempt to erect the assembly in high winds.



Recommended tools for assembly

- Cross head screw driver
- Drill with 2mm diameter drill bit
- Step Ladder

No.	Components	Qty.
1	Upright	2
2	Seat	1
3	Seat back	1
4	Back lattice	1
5	Roof rafter	4
6	Roof slat sets	2
7	Roof top slat	1
8	Finial	6

No.	Fixing kit	Qty.
9	Flat brackets	4
10	60mm screws	16
11	40mm screws	24
12	25mm screws	16
13	40mm nails	62

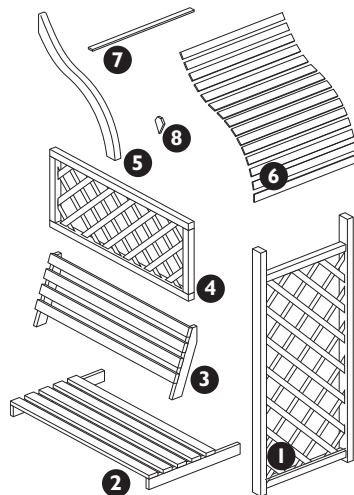

1. Seat slats

Drill four holes in each seat slat bearer as shown in the diagram. Position the seat between the two uprights, 445mm from the bottom of the upright to the top of the seat. Secure through the drilled holes into the upright legs using 8 x 60mm screws.

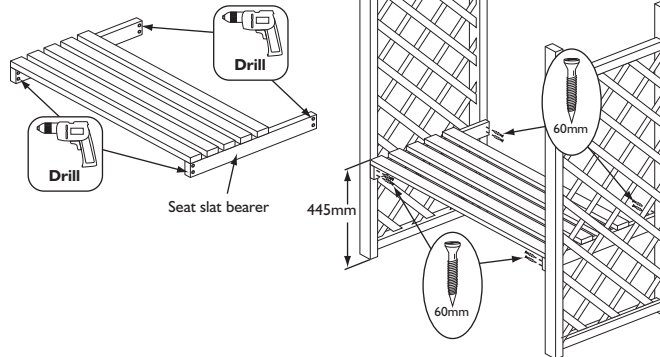

2. Seat back slats

Drill four holes in the seat back as shown in the diagram. Place the seat back on the seat between the two uprights. Secure through the drilled holes into the legs of the uprights using 4 x 60mm screws. Attach the seat back to the seat bearer using a flat bracket and 4 x 25mm screws at each side.

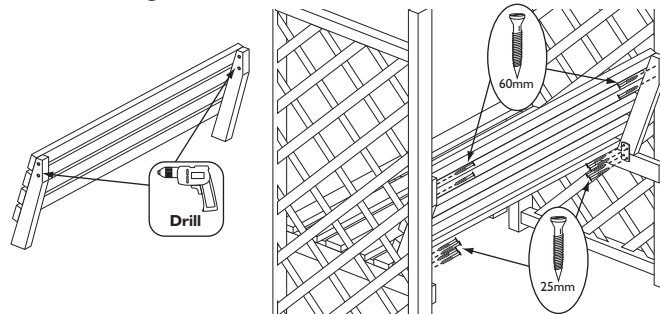

3. Back Lattice

Drill four holes in the back lattice as shown in the diagram. Sit the back lattice on the top of the seat back. Secure through the drilled holes into the legs of the uprights using 4 x 60mm screws.

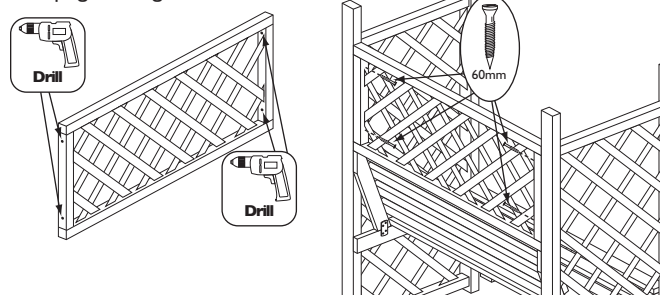

4. Roof rafters

Secure the ends of two roof rafters together using a flat bracket fixed to the side of the rafters with 4 x 25mm screws. On the other side of the rafters secure a finial using 4 x 40mm screws. Assemble a second set of roof rafters in the same way. Place the rafter section onto the uprights as shown. Secure in place by positioning a finial over each leg and rafter join and secure using 4 x 40mm screws per finial.

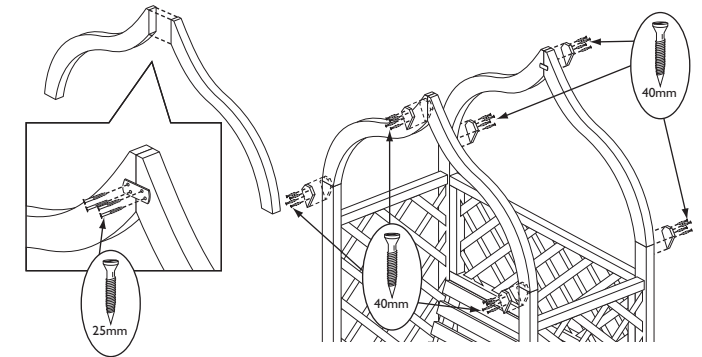

5. Roof slats

Place the roof top slat centrally on the top of the rafters. Secure in place using 2 x 40mm nails. On each side of the rafters evenly space a roof slat set. Secure each slat in place using 2 x 40mm nails.

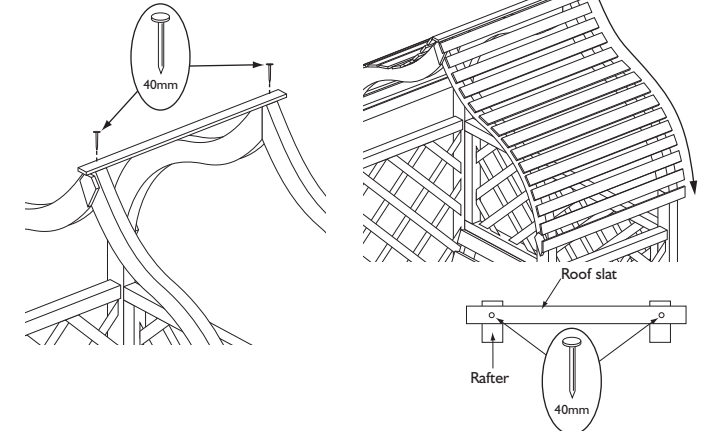

IMPORTANT: RETAIN FOR FUTURE REFERENCE
READ CAREFULLY

Periodically check all fastenings for tightness
For domestic use only

We constantly improve the quality of our products, occasionally the components may differ from the components shown and are only correct at time of printing. We reserve the right to change the specification of our products without prior notice.